

SPECIFICATIONS
 Current Rating: 9A AC,DC
 Voltage Rating: 600V AC,DC
 Temperature Range: -25°C ~ +85°C
 Contact Resistance: 10mΩ Max
 Insulation Resistance: 1000MΩ Min
 Withstanding Voltage: 1500V AC/minute
 Pin Material: Brass

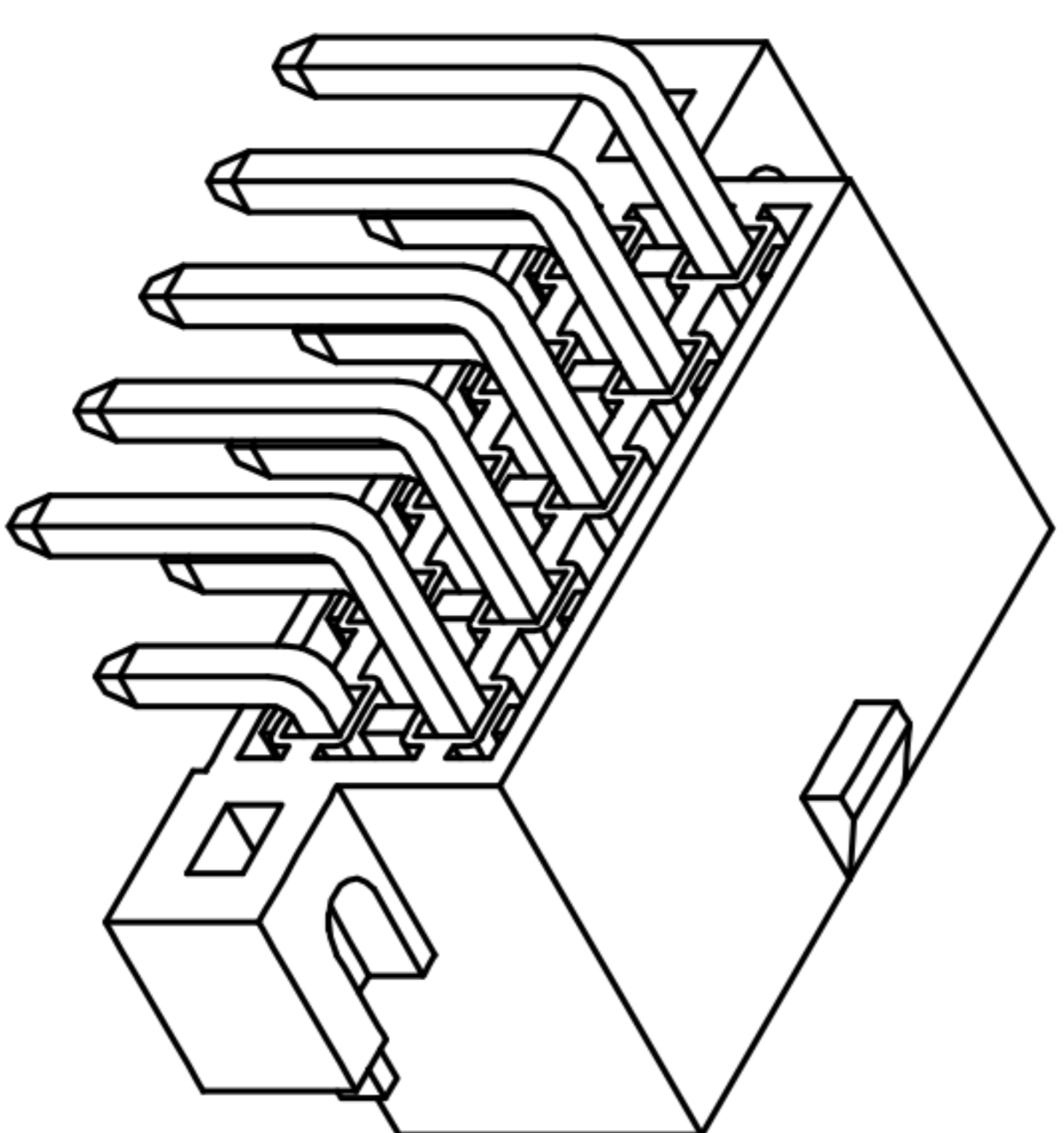
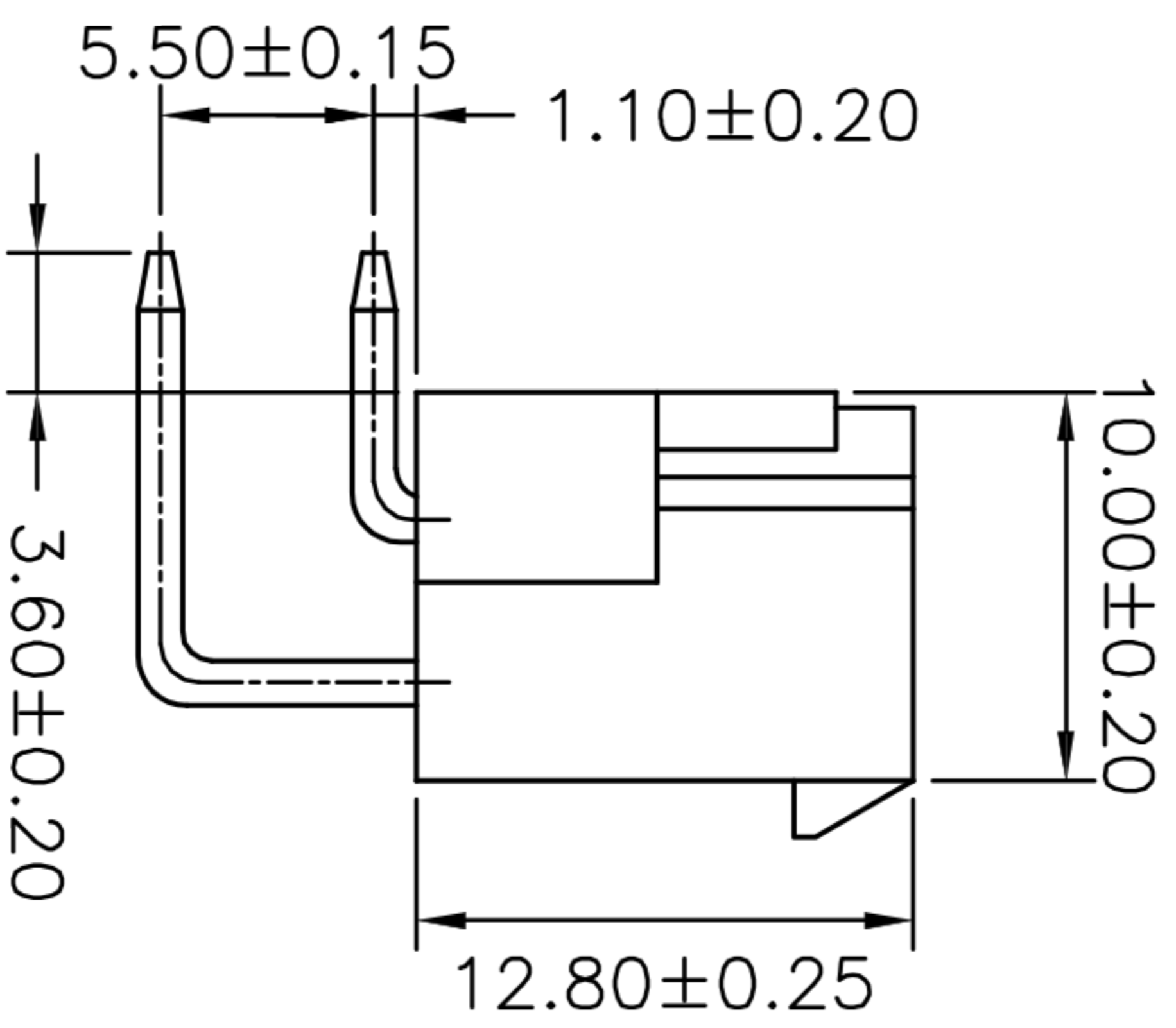
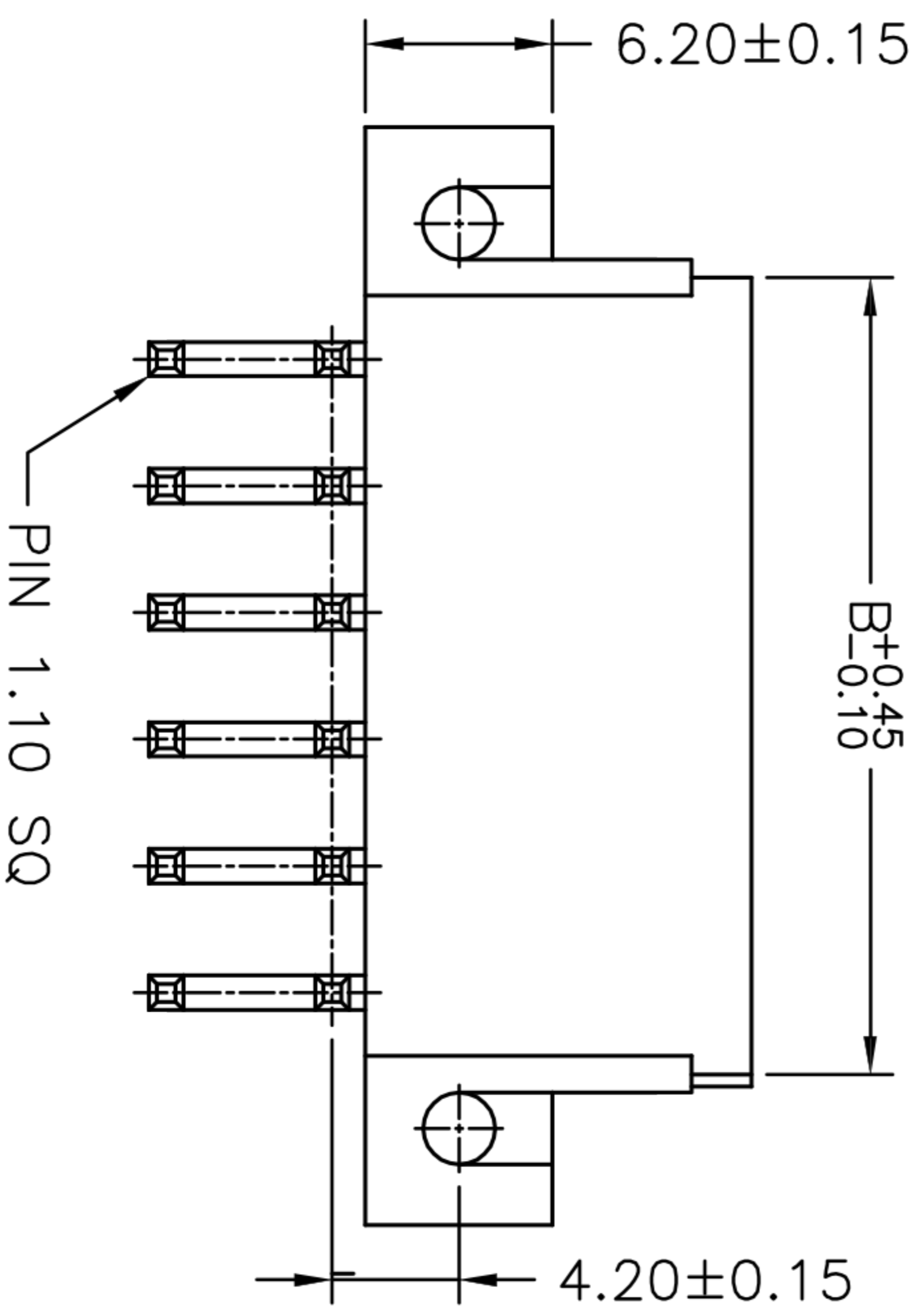

Circuit No.	Dimensions	
	A	B
2X01P	---	5.40
2X02P	4.20	9.60
2X03P	8.40	13.80
2X04P	12.60	18.00
2X05P	16.80	22.20
2X06P	21.00	26.40
2X07P	25.20	30.60
2X08P	29.40	34.80
2X09P	33.60	39.00
2X10P	37.80	43.20
2X11P	42.00	47.40
2X12P	46.20	51.60

ECN NO.	REV.	DATE.	DESCRIPTION.
	A		NEW

APPROVALS		DATE	TITLE:	
DRAWN	ZHIWEI.CHEN	2015.07.07	4.20mm Crimp Style Connector	
CHECKED			PART NO.	GP01-4255WR-2xNP-E
APPROVALS			UNIT:	mm
TOLERANCES ARE		ANGLE	SCALE:	1:1
30~以上	±0.30	±2°	PROJ:	
10~30	±0.20		DRAWING NO.	
5~10	±0.15			
~ 5	±0.10			



深圳市联丰电子有限公司
 SHENZHEN LINFENG ELECTRONIC CO.,LTD