

POLES	PART NO	DIMENSIONS(mm)	
		A	B
2	2	3.96	7.92
3	3	7.92	11.88
4	4	11.88	15.84
5	5	15.84	19.8
6	6	19.8	23.76
7	7	23.76	27.72
8	8	27.72	31.68
9	9	31.68	35.64
10	10	35.64	39.6
11	11	39.6	43.56
12	12	43.56	47.52
13	13	47.52	51.48
14	14	51.48	55.44
15	15	55.44	59.4
16	16	59.4	53.36

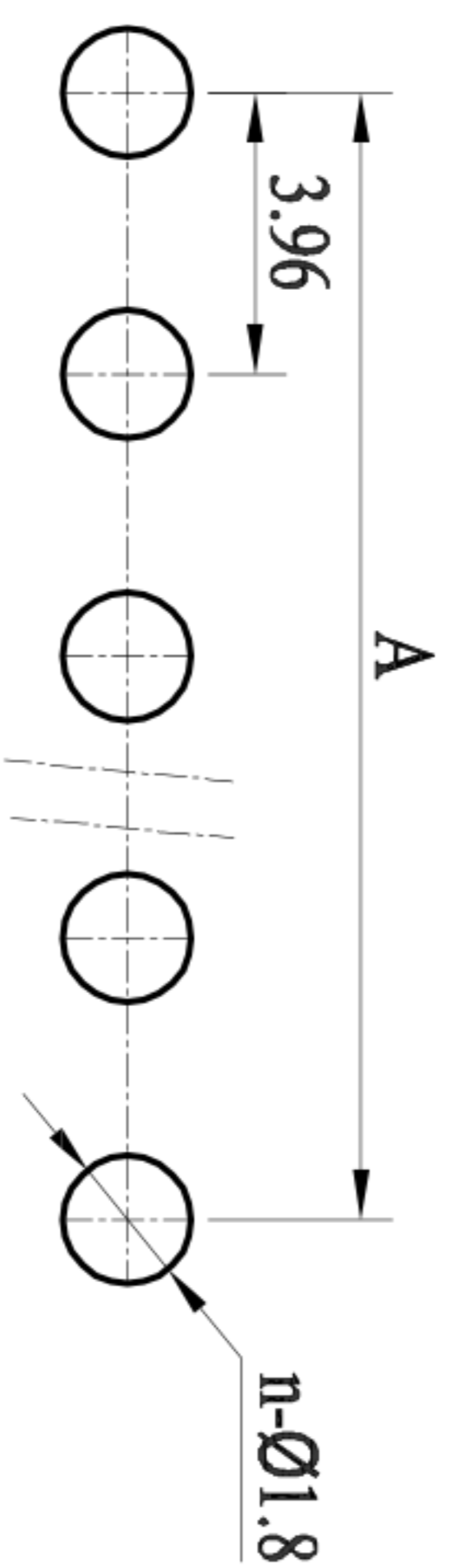

PCB寸法
PCB LAYOUT

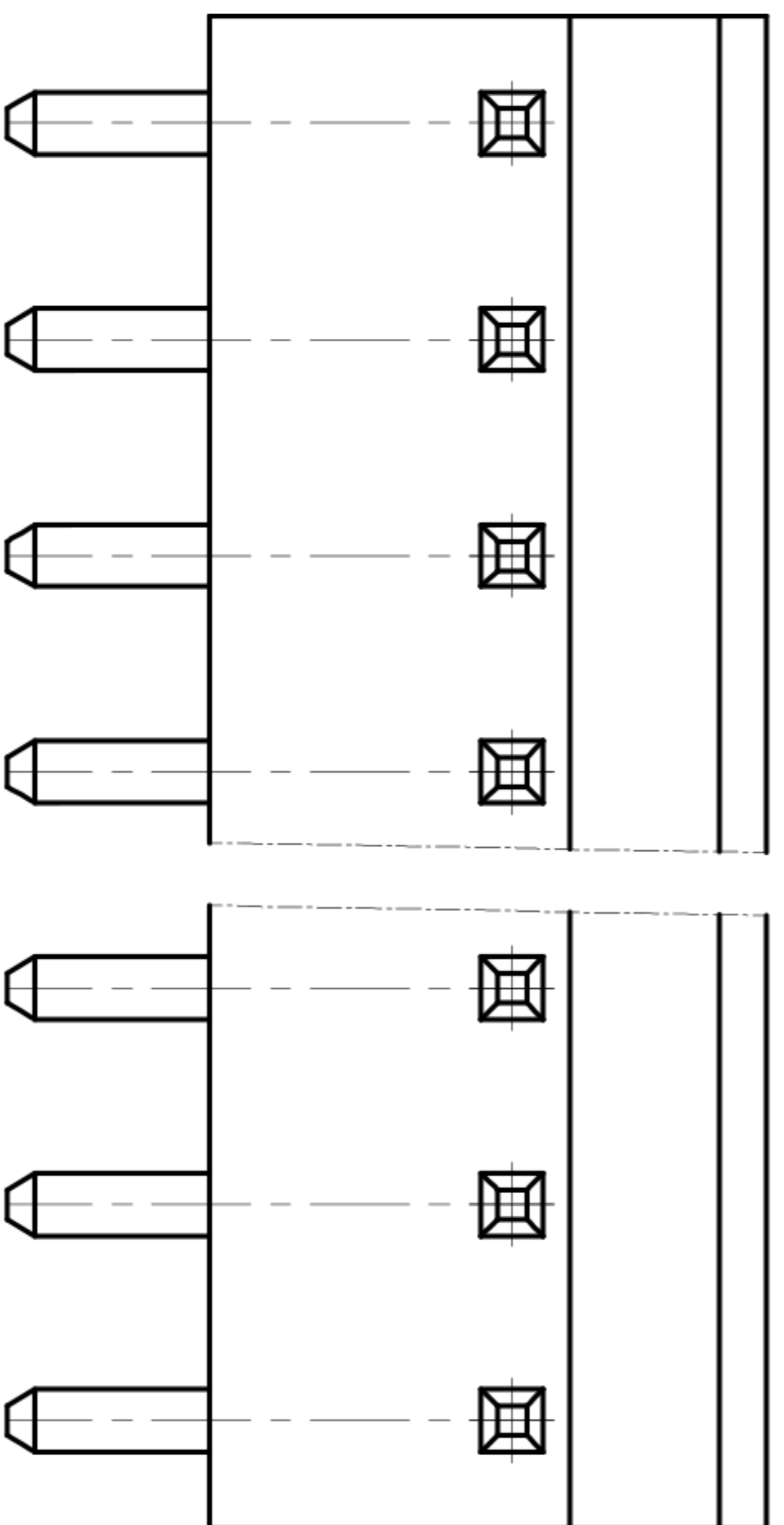
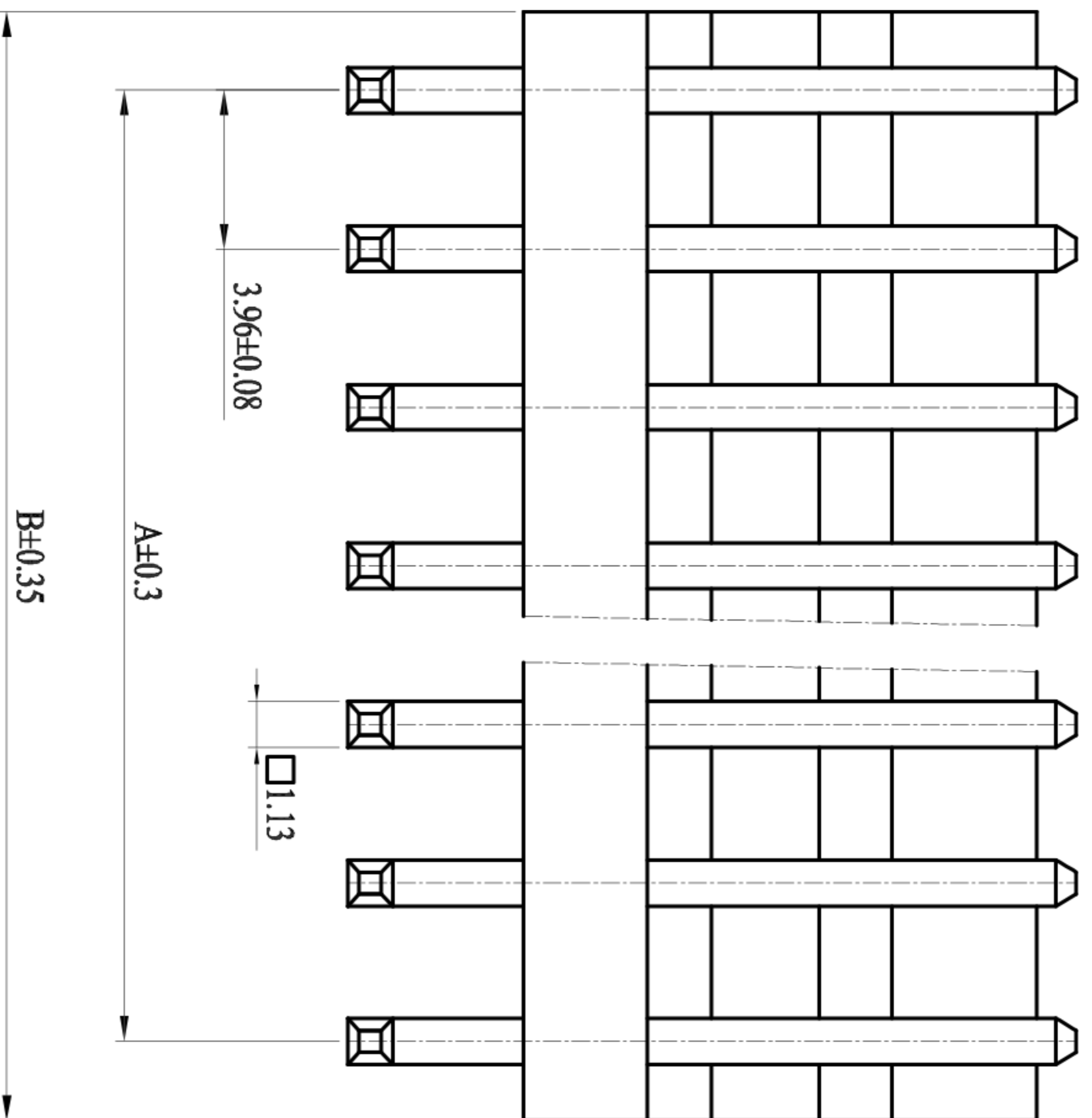
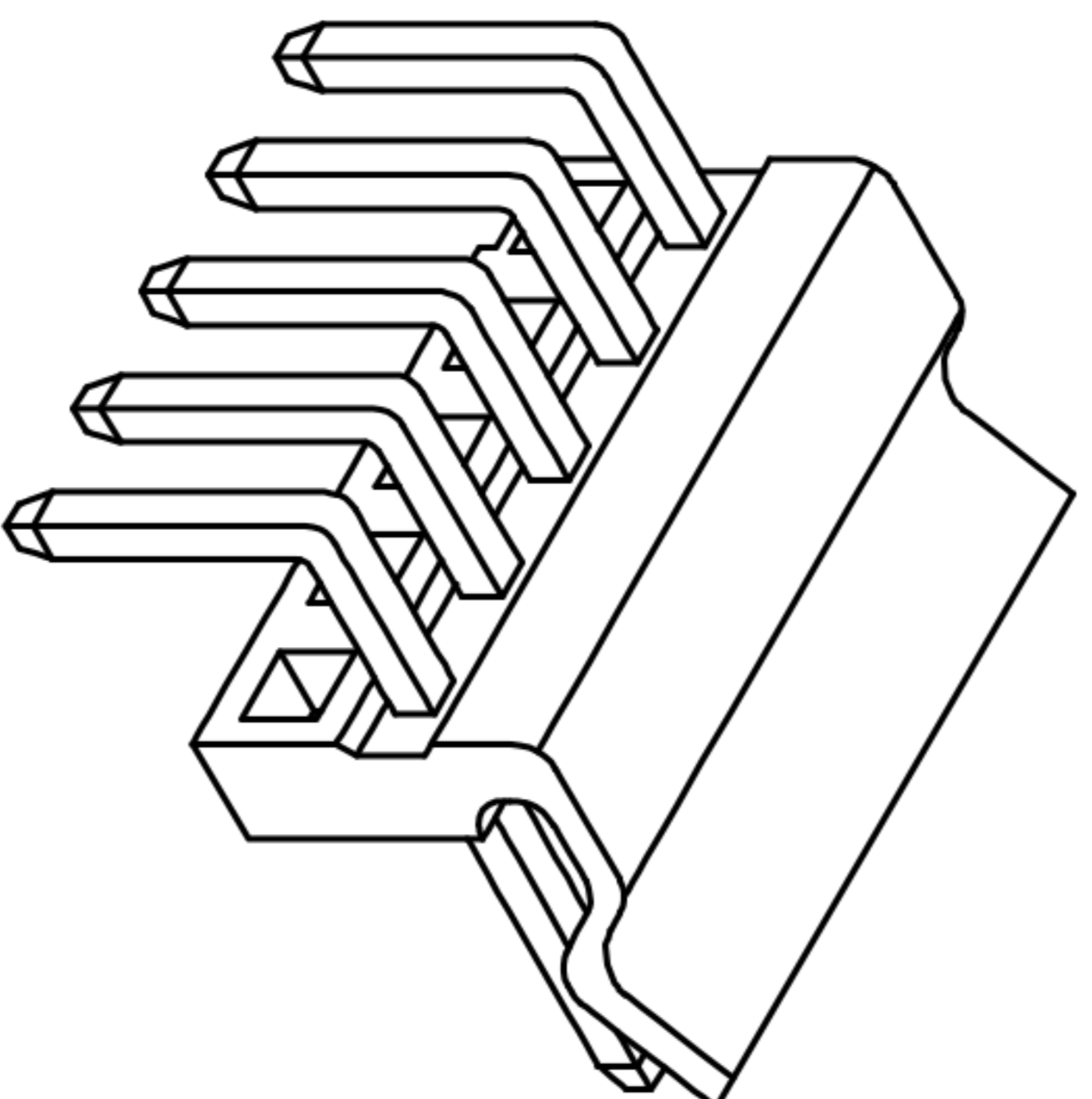
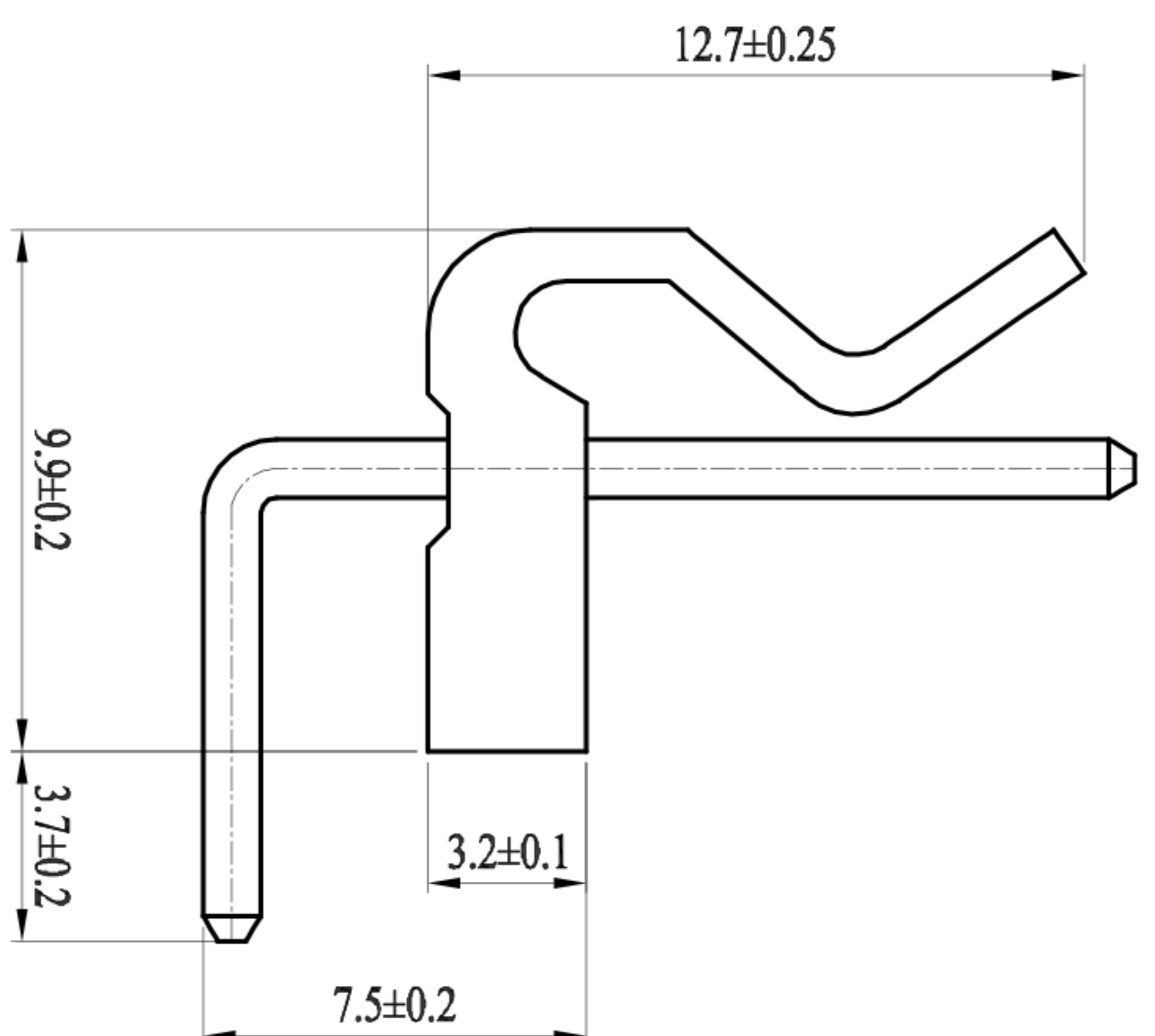

技术参数 (SPECIFICATIONS)

- ◆ 额定电压: 250V AC DC
- ◆ Voltage rating: 250V AC DC
- ◆ 额定电流: 5.0A AC DC MIN
- ◆ Current rating: 5.0A AC DC MIN
- ◆ 耐压值: 1500V AC/minute
- ◆ Withstand voltage: 1500V AC/minute
- ◆ 绝缘电阻: 1000MΩ MIN
- ◆ Insulation resistance: 1000MΩ MIN
- ◆ 接触电阻: 0.02Ω MAX
- ◆ Contact resistance: 0.02Ω MAX
- ◆ 工作温度: -25°C ~ +85°C
- ◆ Working Temperature: -25°C ~ +85°C
- ◆ 间距: 3.96 mm
- ◆ Pitch: 3.96 mm
- 材料 (MATERIAL)
- ◆ 外壳: 尼龙66
- ◆ Housing: PA66

APPROVALS		DATE	TITLE:	
DRAWN	ZHIWEI.CHEN	2015.07.07	PART NO. GP01-3960WR-NP	
CHECKED			UNIT: mm	SCALE: 1:1
APPROVALS				PROJ:
TOLERANCES ARE		30mm以上 ±0.30	ANGLE	±2°
		10~30 ±0.20		
		5~10 ±0.15	DRAWING NO.	
		~ 5 ±0.10		SHEET 1 OF 1

ECN NO.	REV.	DATE.	DESCRIPTION.
	A		NEW
			CHANGE.
			CHECK.
			APPRO.



深圳市联丰电子有限公司
SHENZHEN LINENGYING ELECTRONIC CO.,LTD