

PARTNO	A	B
2P	2.5	7.4
3P	5.0	9.9
4P	7.5	12.4
5P	10.0	14.9
6P	12.5	17.4
7P	15.0	19.9
8P	17.5	22.4
9P	20.0	24.9
10P	22.5	27.4
11P	25.0	29.9
12P	27.5	32.4
13P	30.0	34.9
14P	32.5	37.4
15P	35.0	39.9

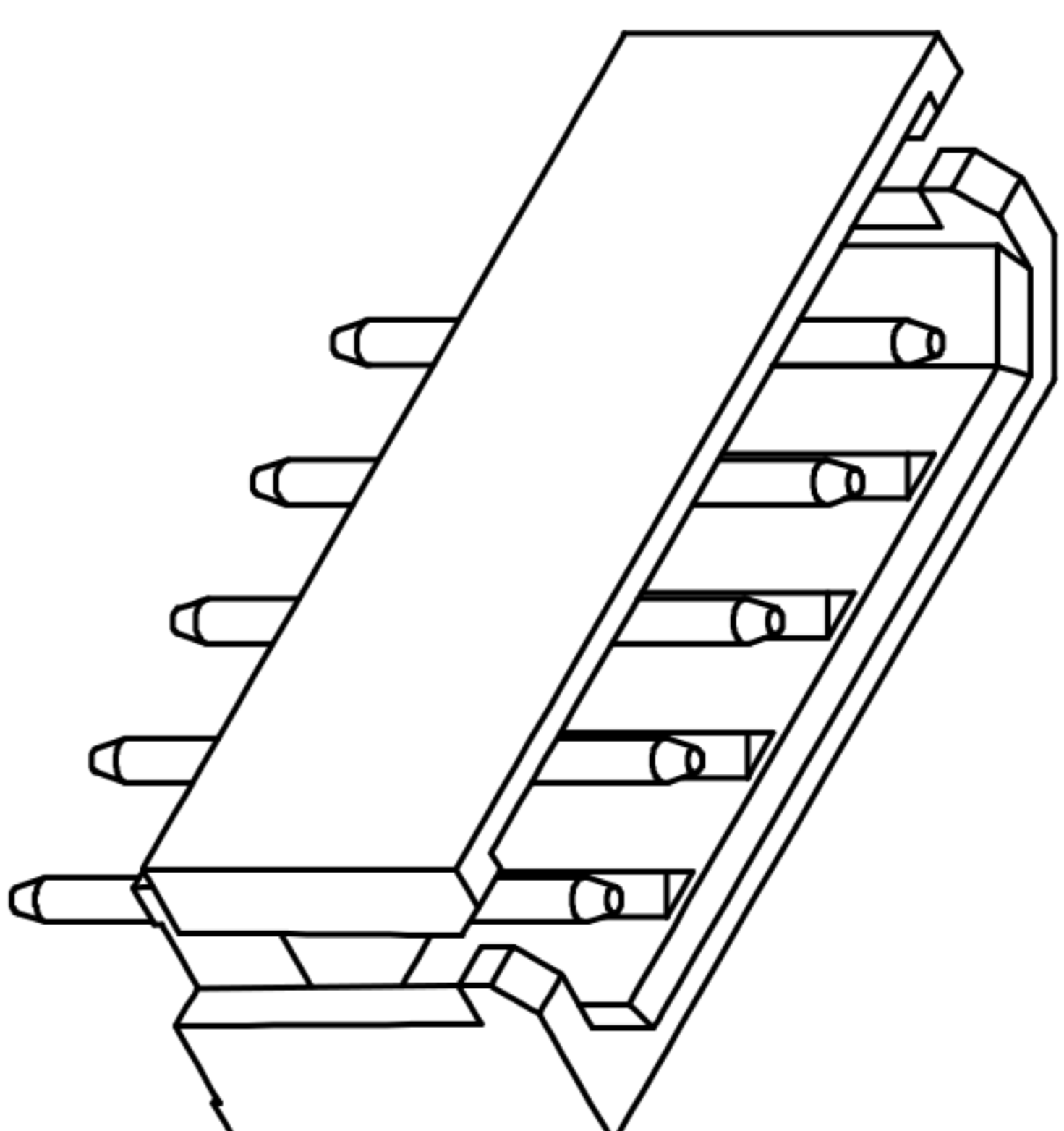

技术参数 (SPECIFICATIONS)

额定电压: 250V AC DC  
 Voltage rating: 250V AC DC  
 额定电流: 2.0A AC DC MIN  
 Current rating: 2.0A AC DC MIN  
 耐压值: 800V AC/minute  
 Withstand voltage: 800V AC/minute  
 绝缘电阻: 1000MΩ MIN  
 Insulation resistance: 1000MΩ MIN  
 接触电阻: 0.02Ω MAX  
 Contact resistance: 0.02Ω MAX  
 工作温度: -25℃ ~ +85℃  
 Working Temperature: -25℃ ~ +85℃  
 间距: 2.5mm  
 Pitch: 2.5mm  
 材料 (MATERIAL)  
 外壳: 尼龙66  
 Housing: PA66  
 插针: 黄铜  
 Pin: Brass

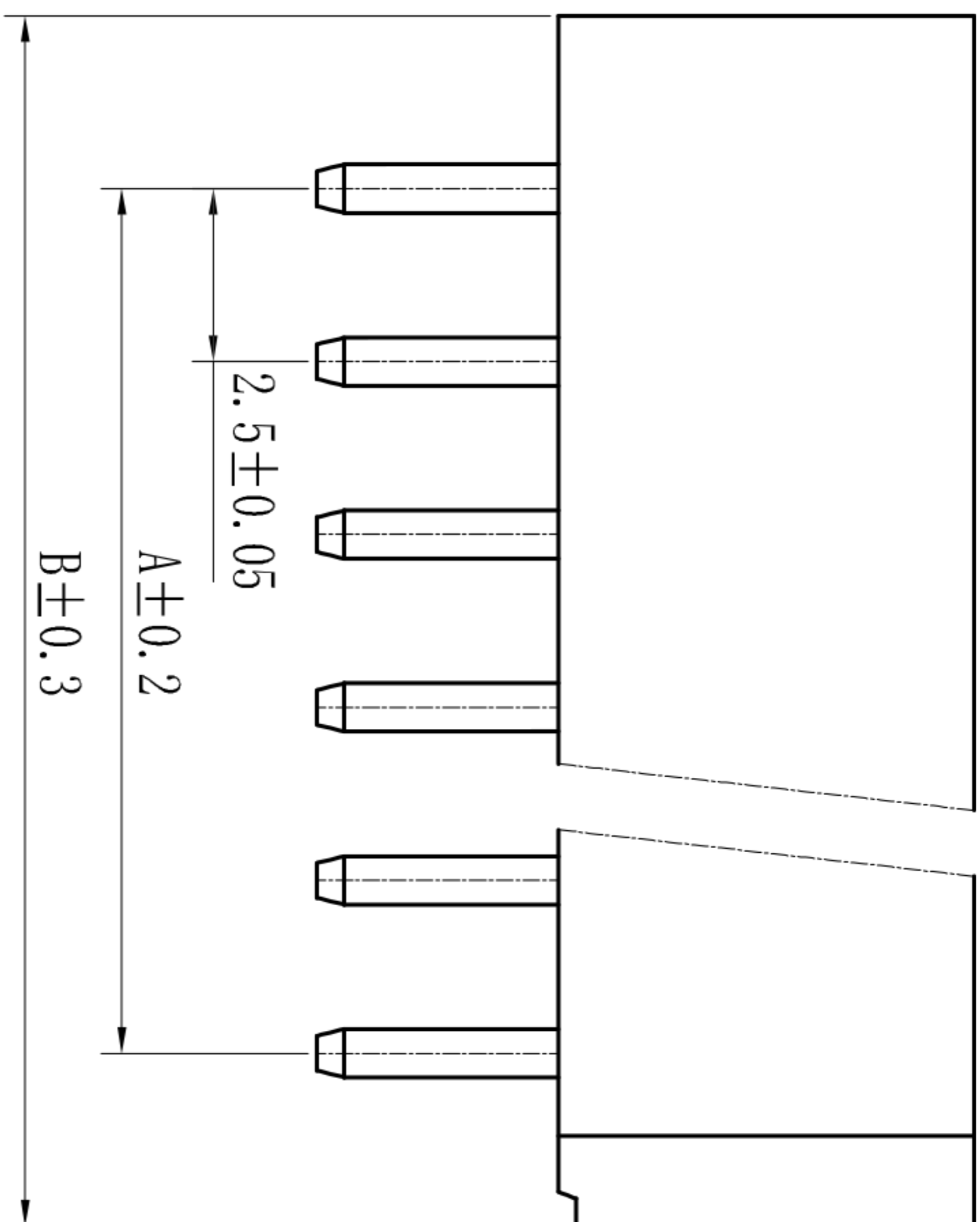
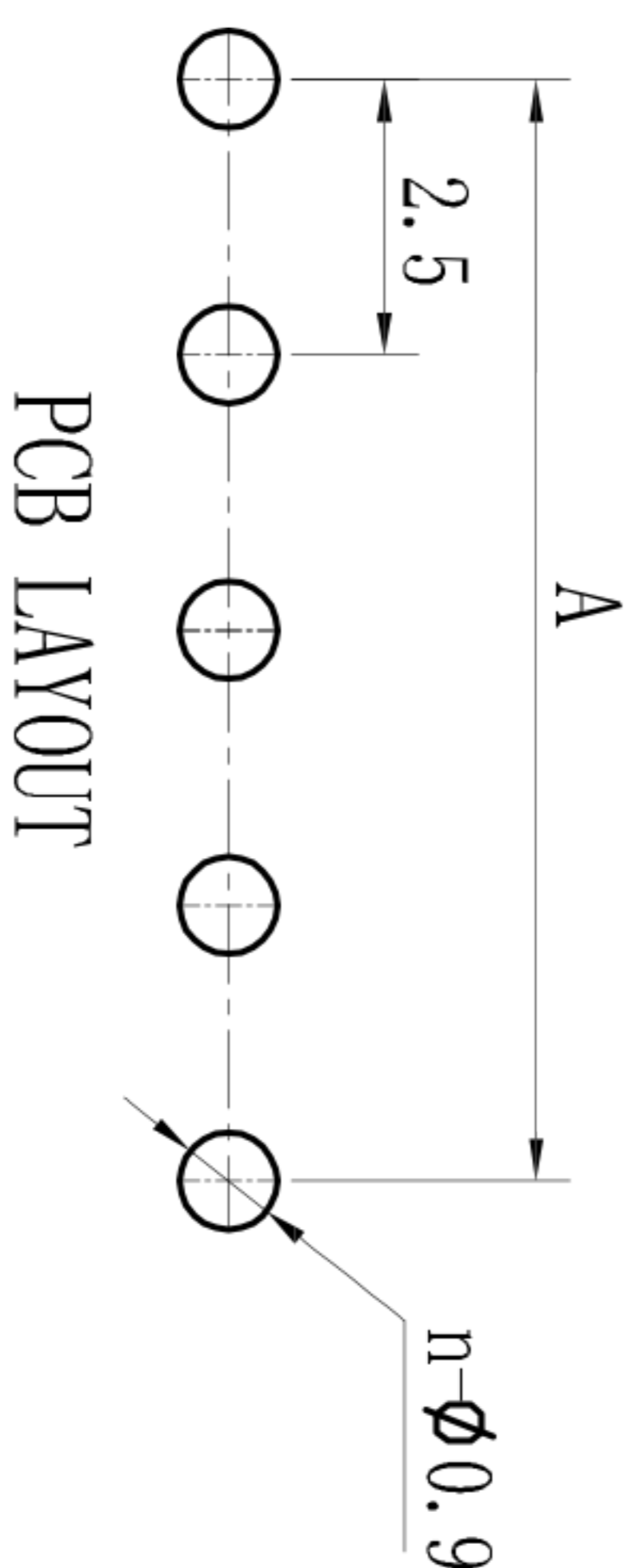
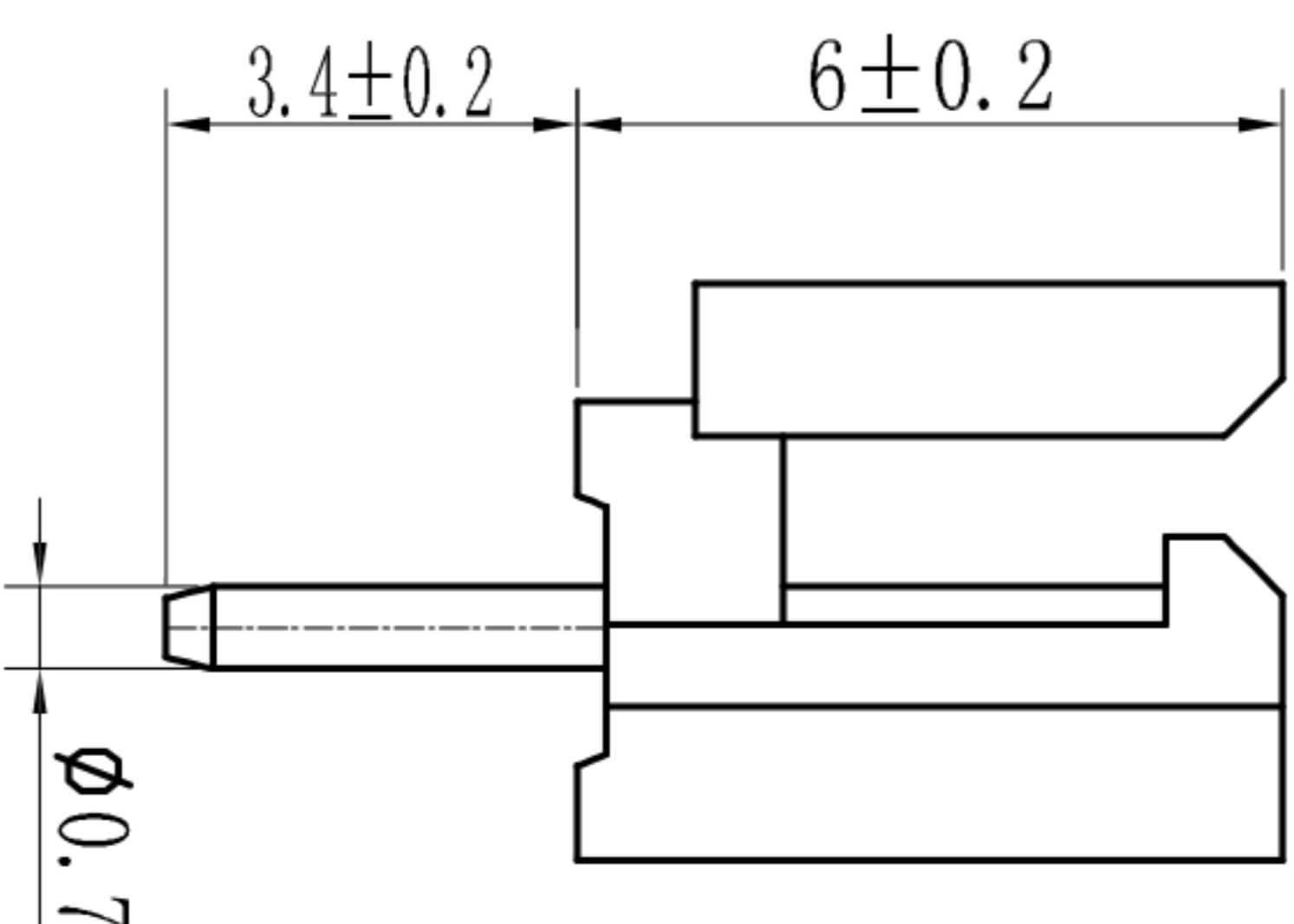
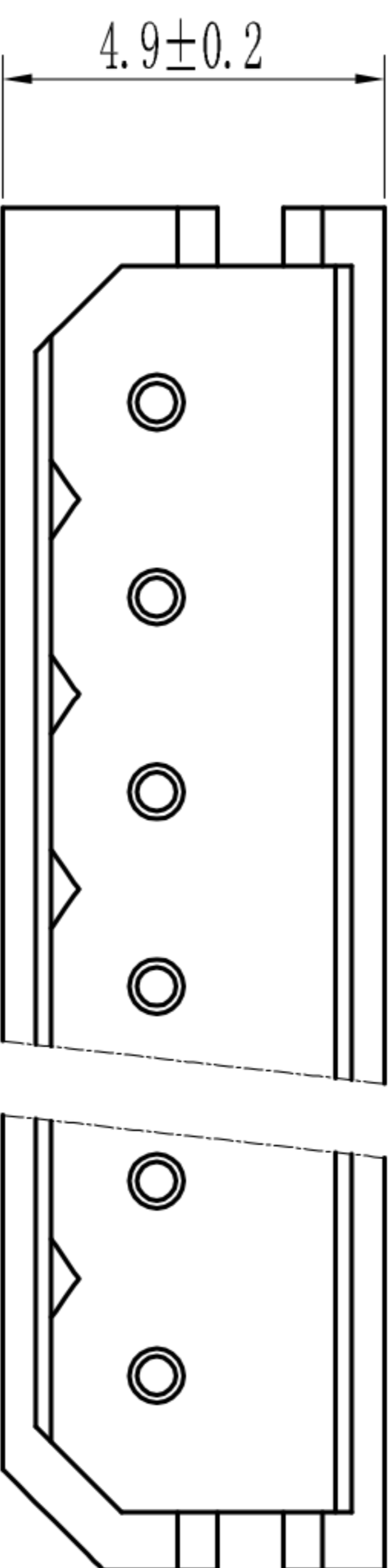

ECN NO.	REV.	DATE.	DESCRIPTION.
—	A	—	NEW

APPROVALS		DATE	TITLE:	
DRAWN	ZHIWEI.CHEN	2015.07.07	PART NO.	GP01-2506W-NP
CHECKED			UNIT: mm	SCALE: 1:1
APPROVALS			DRAWING NO.	PROJ:
TOLERANCES ARE				SHEET 1 OF 1
30~以上	±0.30	ANGLE	±2°	
10~30	±0.20			
5~10	±0.15			
~ 5	±0.10			



深圳市联丰电子有限公司  
SHENZHEN LINFENG ELECTRONIC CO.,LTD