

P.C.B. LAYOUT

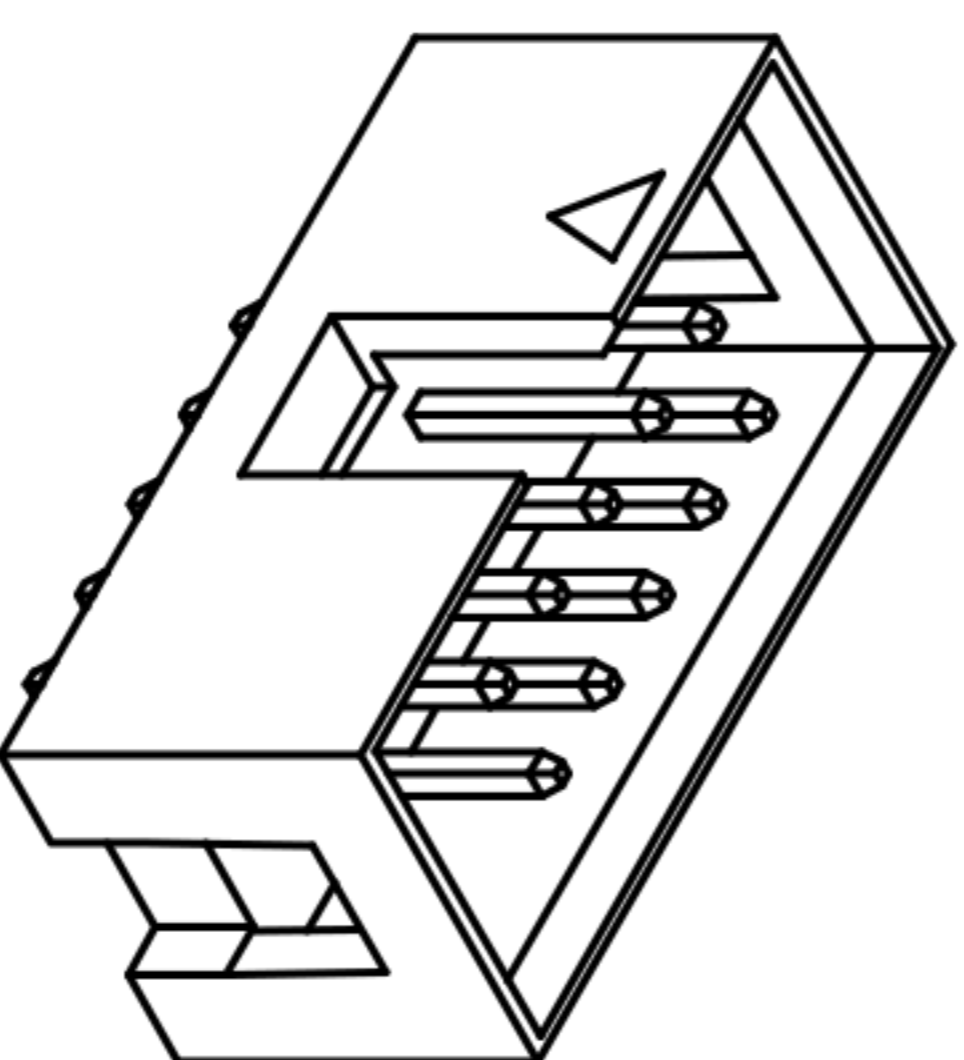
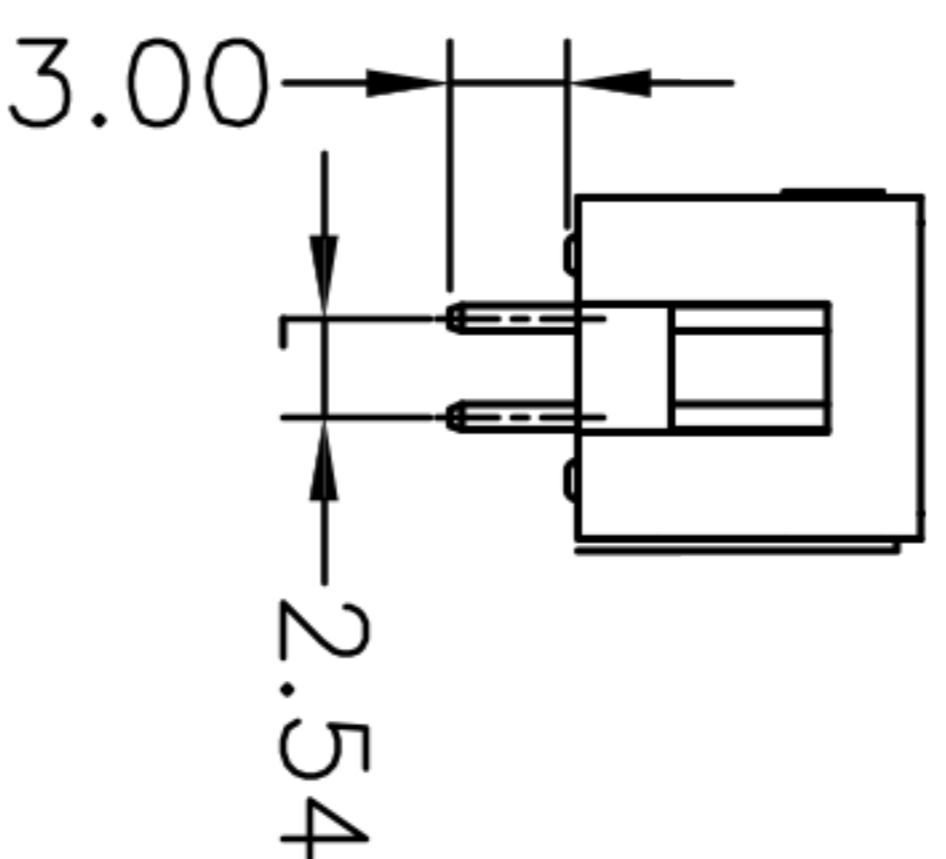

SPECIFICATIONS
 Current Rating: 3A AC,DC
 Temperature Range: -25°C ~ +85°C
 Contact Resistance: 20mΩ Max.
 Insulation Resistance: 1000MΩ Min.
 Withstanding Voltage: 1000V AC/minute
 Pin Material: Brass/Gold-Flash
 Material: PBT
 Color: Black

Circuit No.	Dimensions			Circuit No.	Dimensions		
	A	B	C		A	B	C
2X02P	2.54	12.58	10.28	2X22P	53.34	63.38	61.08
2X03P	5.08	15.12	12.82	2X23P	55.88	65.92	63.62
2X04P	7.62	17.66	15.36	2X24P	58.42	68.46	66.16
2X05P	10.16	20.20	17.90	2X25P	60.96	71.00	68.70
2X06P	12.70	22.74	20.44	2X26P	63.50	73.54	71.24
2X07P	15.24	25.28	22.98	2X27P	66.04	76.08	73.78
2X08P	17.78	27.82	25.52	2X28P	68.58	78.62	76.32
2X09P	20.32	30.36	28.06	2X29P	71.12	81.16	78.86
2X10P	22.86	32.90	30.60	2X30P	73.66	83.70	81.40
2X11P	25.40	35.44	33.14	2X31P	76.20	86.24	83.94
2X12P	27.94	37.98	35.68	2X32P	78.74	88.78	86.48
2X13P	30.48	40.52	38.22	2X33P	81.28	91.32	89.02
2X14P	33.02	43.06	40.76	2X34P	83.82	93.86	91.56
2X15P	35.56	45.60	43.30	2X35P	86.36	96.40	94.10
2X16P	38.10	48.14	45.84	2X36P	88.90	98.94	96.64
2X17P	40.64	50.68	48.38	2X37P	91.44	101.48	99.18
2X18P	43.18	53.22	50.92	2X38P	93.98	104.02	101.72
2X19P	45.72	55.76	53.46	2X39P	96.52	106.56	104.26
2X20P	48.26	58.30	56.00	2X40P	99.06	109.10	106.80
2X21P	50.80	60.84	58.54				

ECN NO.	REV.	DATE.	DESCRIPTION.	CHANGE.	CHECK.	APPRO.
	A		NEW			

APPROVALS		DATE	TITLE:	
DRAWN	ZHIWEI.CHEN	2015.07.07	2.54mm Crimp Style Connector	
CHECKED			PART NO. GP23-2523WV-2XNP	
APPROVALS			SCALE: 1:1	
TOLERANCES ARE		ANGLE	DRAWING NO.	
30~以上	±0.30	±2°	PROJ. SHEET 1 OF 1	
10~30	±0.20			
5~10	±0.15			
~ 5	±0.10			



深圳市联丰电子有限公司
 SHENZHEN LIANFENG ELECTRONIC CO.,LTD