

TOP VIEW

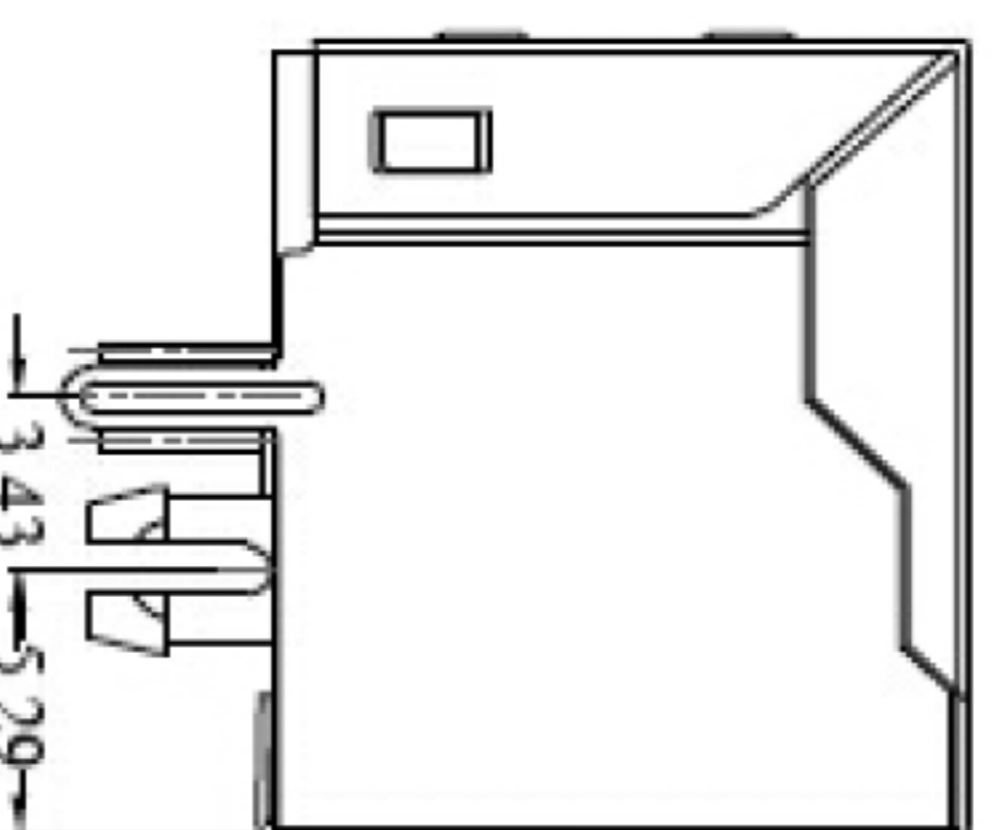

LEFT SIDE VIEW

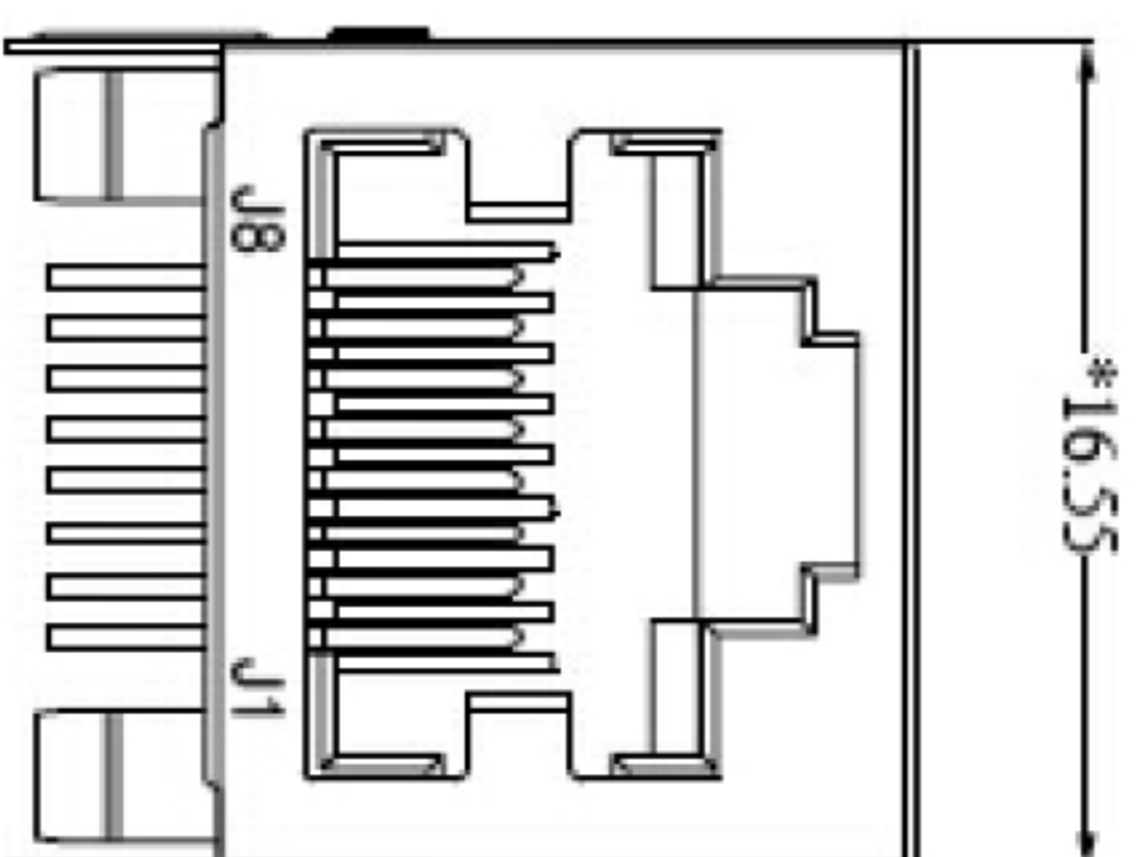

FRONT VIEW

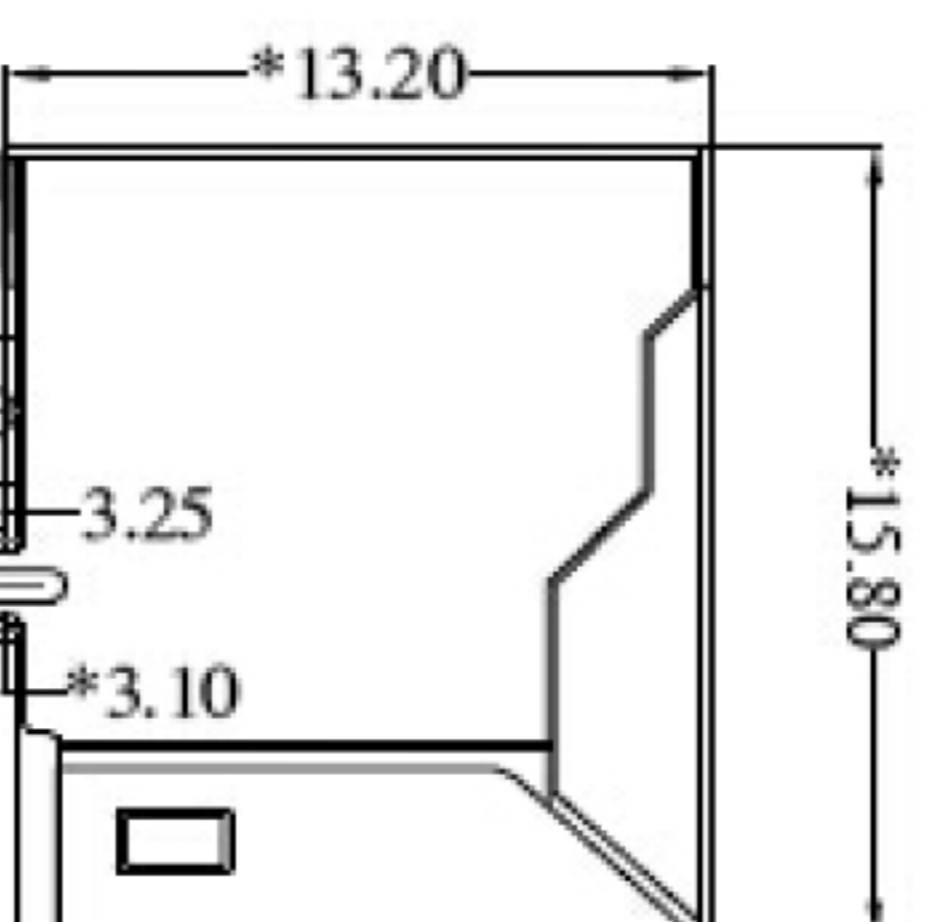

RIGHT SIDE VIEW

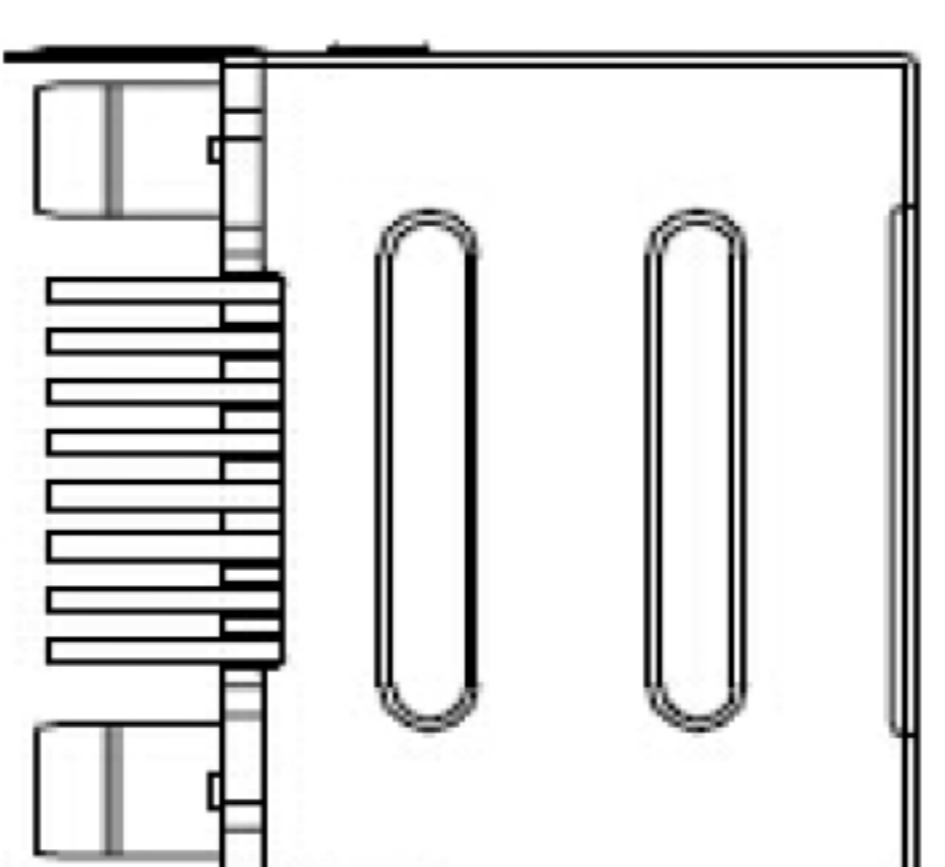

BACK VIEW

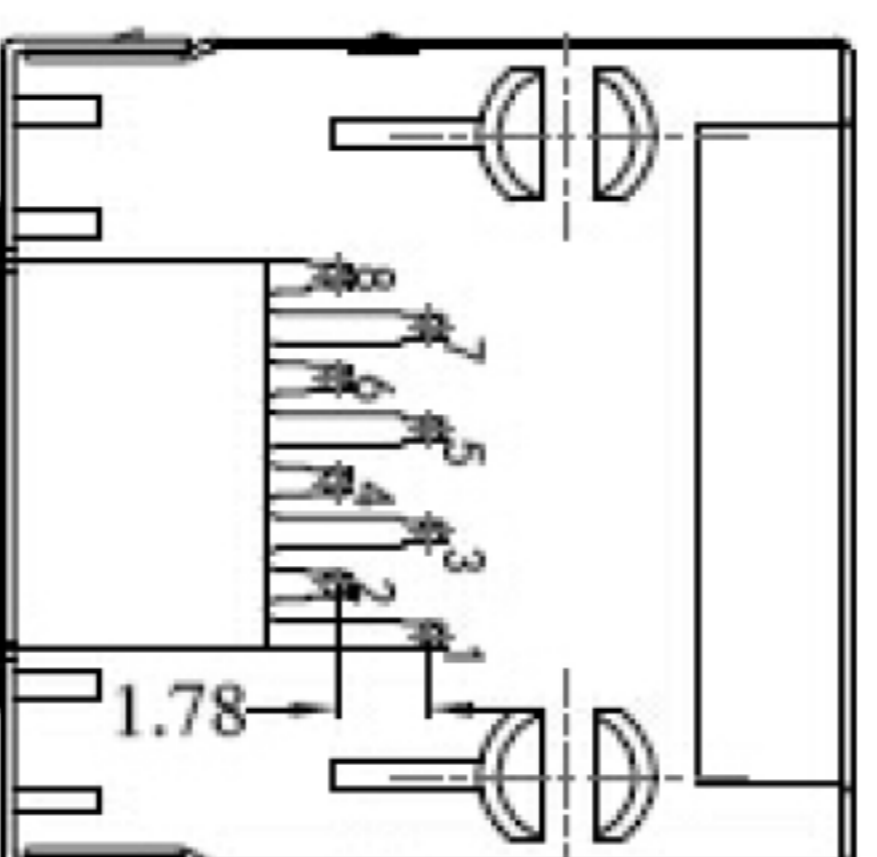

BOTTOM VIEW

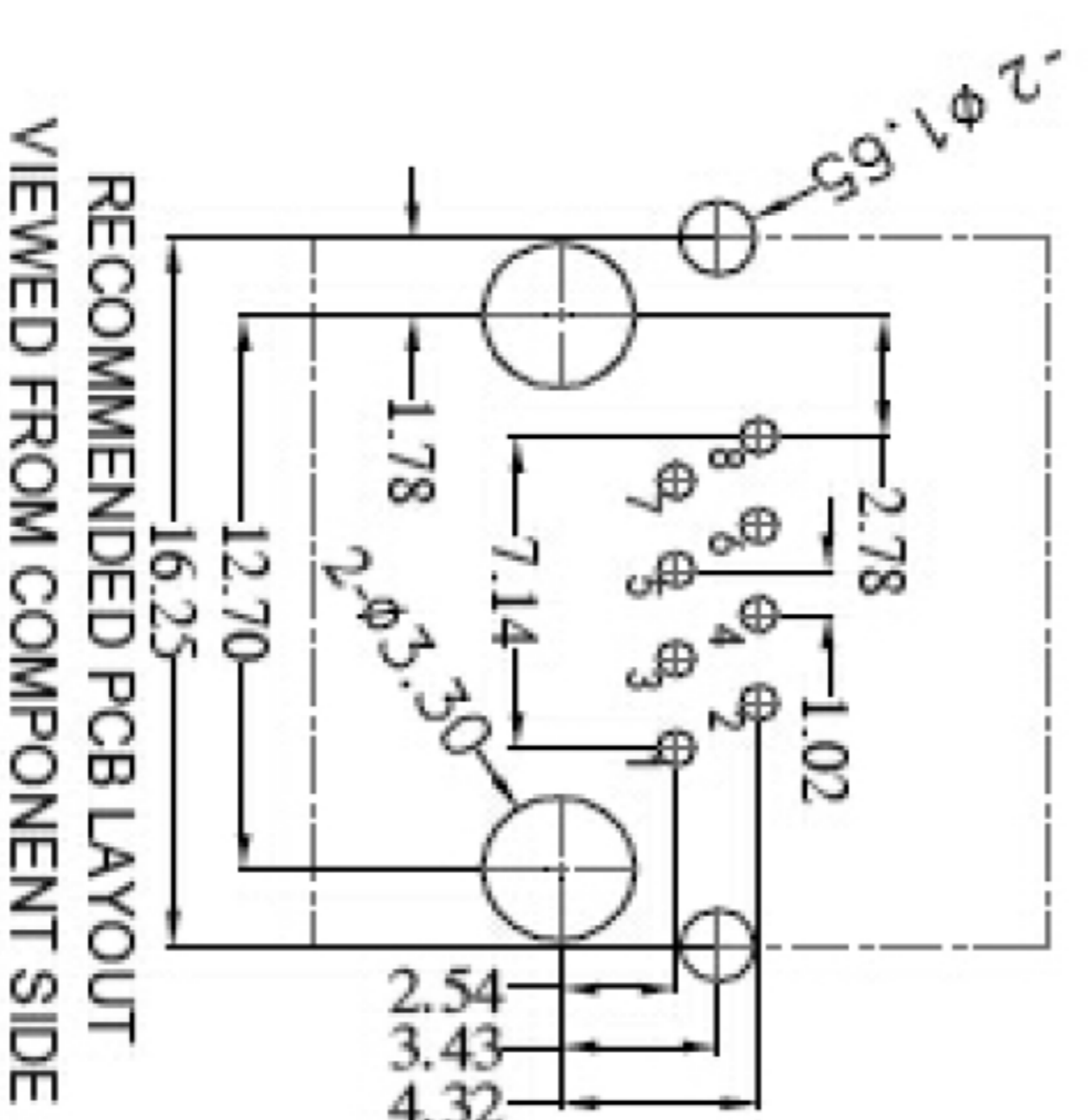

RECOMMENDED PCB LAYOUT  
VIEWED FROM COMPONENT SIDE

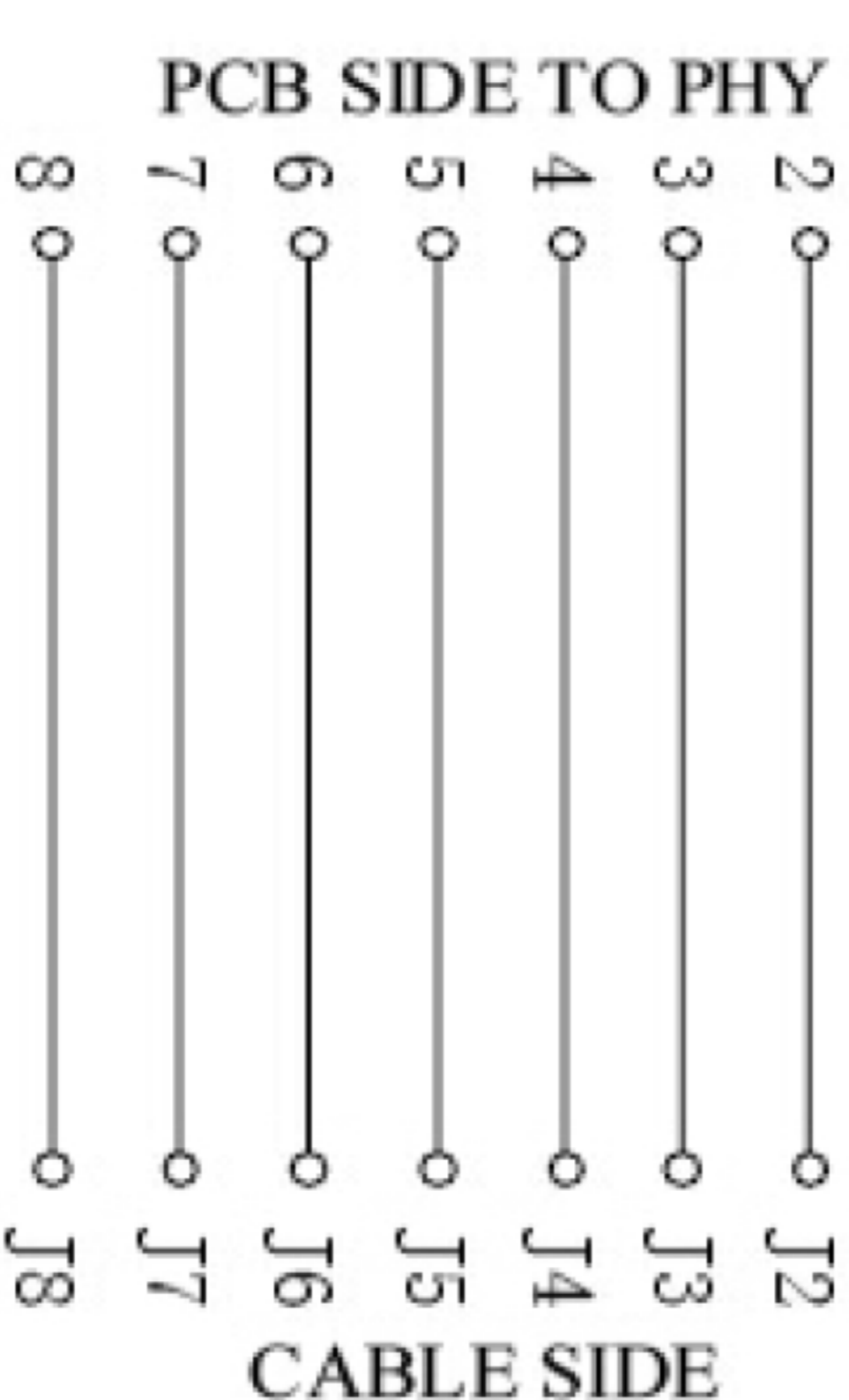

**MATERIAL:**  
HOUSING: PA46,UL94V-0,BLACK.  
TERMINAL: PHOSPHOR BRONZE Ø=0.46MM, 0.6U" GOLD PLATING.  
SHIELD: C2680,T=0.20MM,20U" MIN NICKEL PLATING  
ON ALL AREA

**MACHANICAL:**  
DURABILITY: 750 CYCLES MIN,12.5MM/MINUTE.  
INSERTION FORCE: 2.2KG.F MAX.  
RENTENTION STRENGTH : 7.7KG.F BETWEEN JACK AND PLUG.  
OPERATING TEMPERATURE: -40℃~+85℃.  
STORAGE TEMPERATURE: -40℃~+85℃.  
ALL CRITICAL DIMENSIONS WITH "MM"

**ELECTRICAL:**  
VOLTAGE: 125 VOLTS AC.  
CURRENT RATING : 1.5AMP.  
DIELECTRIC STRENGTH : 1000 VAC RMS 50HZ OR 60HZ,1 MIN.  
INSULATION RESISTANCE: 500 MEGA OHMS MIN. INITIAL  
AFTER 500V DC FOR 1 MINUTE.

CONTACT RESISTANCE: SINGLE TERMINAL 30 MILLIOHMS MAX  
INITIAL 50 MILLIOHMS MAX AFTER  
DURABILITY TEST.

APPROVALS		DATE		
DRAWN	ZHIWEI CHEN	2015.07.07	深圳市联丰电子有限公司 SHENZHEN LIANFENG ELECTRONIC CO.,LTD	
CHECKED			TITLE:	RJ CONNECTOR
APPROVALS			PART NO.	RJ45-GW11-DDN-AB-88-B1

ECN NO.	REV.	DATE.	DESCRIPTION.	CHANGE.	CHECK.	APPRO.	TOLERANCES ARE	UNIT: mm	SCALE: 1:1	SHEET 1 OF 1
	A		NEW				30° B/L ±0.30 10° 30 ±0.20 5 10 ±0.15 - 5 ±0.10	mm		